

© 2017 HTC Corporation.  
All rights reserved.

HTC and the HTC logo are  
trademarks of HTC Corporation.  
microSD is a trademark of SD-3C  
LLC.

All other company, product and  
service names mentioned herein are  
trademarks, registered trademarks  
or service marks of their respective  
owners.

[htc.com](http://htc.com)



91H0xxxx-xxM Rev.A

# HTC U11

## Inserting nano SIM and microSD cards

### IMPORTANT:

#### Use a standard nano SIM only.

Don't cut a micro or regular SIM card and insert it into the nano SIM slot. It's thicker than the standard nano SIM card and may get stuck in the slot.

#### Don't disassemble any part of the phone.

Don't try to open the phone or remove the battery by force. This may damage the phone or its electronics and will invalidate the warranty.

#### Don't throw the tray away.

You need it to insert your nano SIM and microSD™ cards.

1

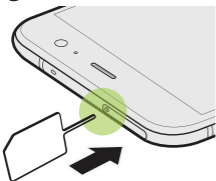

1. With the phone facing up, insert the tip of the tray eject tool that came in the box (or a small bent paperclip) into the tray eject hole. Push the tip all the way into the hole until the card tray ejects.

Pull the tray out.

2

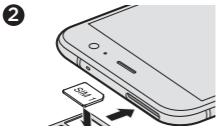

2. With the nano SIM card's gold contacts facing **down**, place the card into the SIM holder of the tray.

Make sure to align the cut-off corner to the notch on the holder.

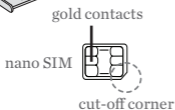

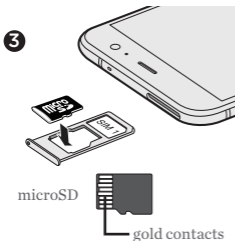

3. With the microSD card's gold contacts facing *down* and narrow side facing *in*, place the card into the SD holder of the tray.
4. When reinserting the tray, make sure it is facing *up* so that the cards don't fall out. Hold the tray with the microSD card holder between your fingers, and then steadily slide the tray all the way into the slot.

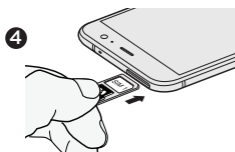

## Restarting the phone

To restart your phone when it doesn't respond to touch screen or button presses, press and hold the **POWER** and **VOLUME DOWN** buttons (for 12 to 15 seconds) until the phone vibrates, and then release the buttons.

## Need help?

Check out our friendly walkthroughs and self-help in troubleshooting basic problems with the HTC Help app. From the Home screen, tap , and then find and tap **Help**. Or go to [www.htc.com/support/](http://www.htc.com/support/) to find tutorials, the user guide, and more. Please also read the Safety and regulatory guide that's included in the box.

## Water and dust resistant IP67

To prevent water, dust and other contaminants from entering the nano SIM and microSD slot, close the slot cover tightly.

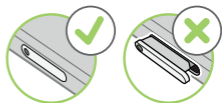

Make sure the cover does not protrude from the side.

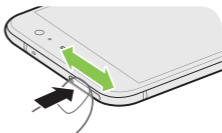

Do not attempt to charge or otherwise use the USB port when your HTC U11 is wet.



Do not expose the phone to or let the USB port come in contact with the following:



Soap/detergent  
/shower gel



Swimming pool water  
/sea water/hot water



Sand

- Water containing soap, detergent, or shower gel
- Sea water, swimming pools, spas, hot water, and hot springs
- Any liquid besides tap water such as alcohol, juices, and condiments
- Sand

For more tips on maintaining water and dust resistance for your phone, see the user guide, support site, or the HTC Help app. Also make sure to read the Safety guide that comes with the phone.